

INFO-SHEET

Steel Sheet Pile

SEPT. 11



ArcelorMittal

GU 20N

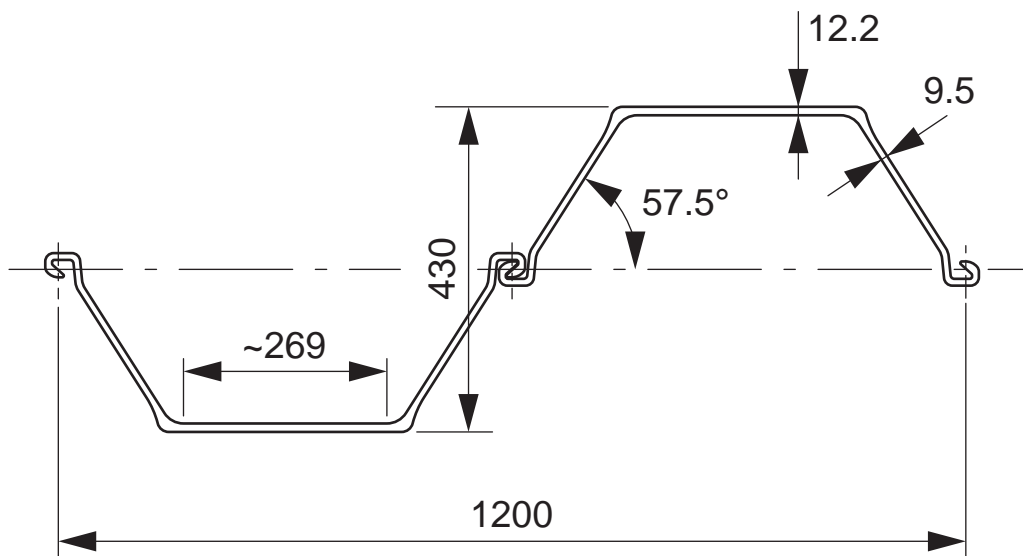

scale: 1/10

	Sectional area	Mass	Moment of inertia	Elastic section modulus	Plastic section modulus	Static moment	Radius of gyration	Coating area *
	cm ²	kg / m	cm ⁴	cm ³	cm ³	cm ³	cm	m ² / m
Single Pile	103.4	81.1	7 480	495			8.51	0.87
Double Pile	206.8	162.3	49 580	2 305			15.49	1.72
Triple Pile	310.2	243.5	68 600	2 655			14.87	2.58
Per m of wall	172.3	135.2	41 320	1 920	2 280	1 125	15.49	1.43

ArcelorMittal reserves the right to change the section properties without prior notice

* 1 side, excluding inside of interlocks

ArcelorMittal Commercial RPS S.à r.l.
 Sheet Piling
 66, rue de Luxembourg
 L-4221 Esch sur Alzette | Luxembourg

T +352 5313 3105
 F +352 5313 3290
www.arcelormittal.com/sheetpiling
sheetpiling@arcelormittal.com

05.09.2011

FICHE D'INFORMATION

Palplanche

SEPT. 11



ArcelorMittal

GU 20N

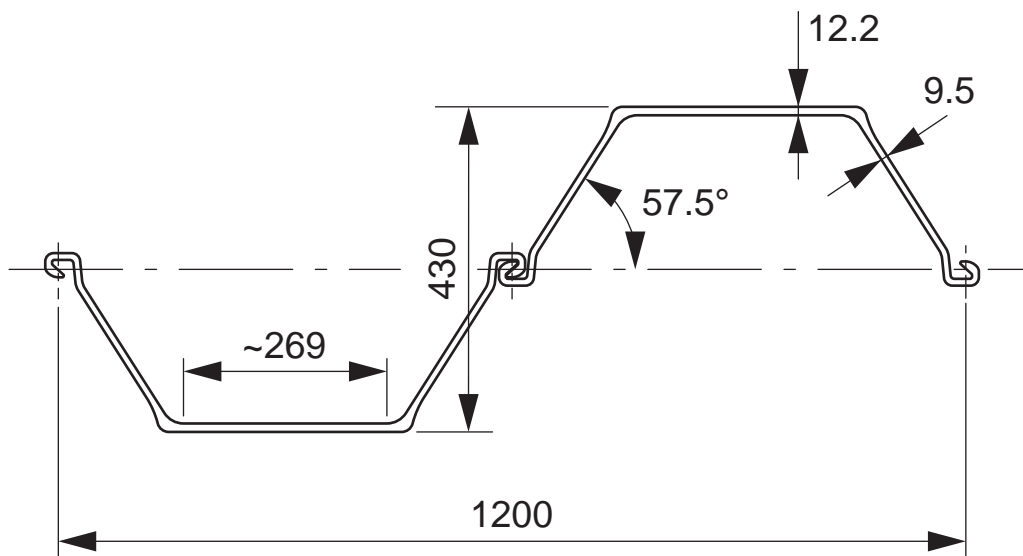

échelle: 1/10

	Section d'acier cm ²	Masse kg / m	Moment d'inertie cm ⁴	Module de flexion élastique cm ³	Module de flexion plastique cm ³	Moment statique cm ³	Rayon de giration cm	Surface à traiter * m ² / m
Palpl. simple	103.4	81.1	7 480	495			8.51	0.87
Palpl. double	206.8	162.3	49 580	2 305			15.49	1.72
Palpl. triple	310.2	243.5	68 600	2 655			14.87	2.58
Par ml de rideau	172.3	135.2	41 320	1 920	2 280	1 125	15.49	1.43

ArcelorMittal se réserve le droit de modifier les caractéristiques de ses profils sans préavis

* 1 côté, intérieur des serrures exclu

ArcelorMittal Commercial RPS S.à r.l.
Palplanches
66, rue de Luxembourg
L-4221 Esch sur Alzette | Luxembourg

T +352 5313 3105
F +352 5313 3290
www.arcelormittal.com/palplanches
palplanches@arcelormittal.com

05.09.2011

PROFILDATENBLATT

Spundwand

SEPT. 11



ArcelorMittal

GU 20N

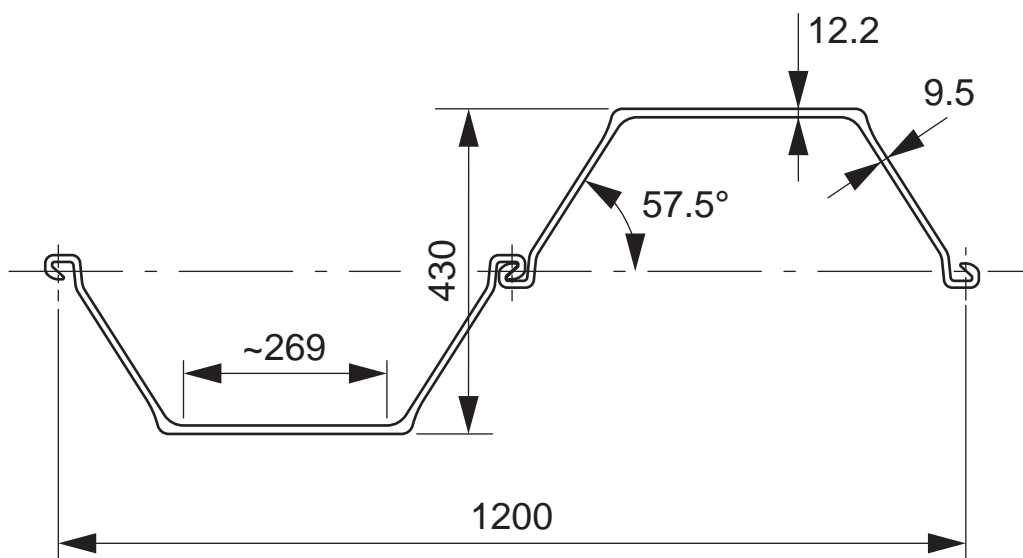

Masstab: 1/10

	Querschnittsfläche	Eigenlast	Trägheitsmoment	Elastisches Widerstandsmoment	Plastisches Widerstandsmoment	Statisches Moment	Trägheitshalbmesser	Anstrichfläche *
	cm ²	kg / m	cm ⁴	cm ³	cm ³	cm ³	cm	m ² / m
Einzelbohle	103.4	81.1	7 480	495			8.51	0.87
Doppelbohle	206.8	162.3	49 580	2 305			15.49	1.72
Dreifachbohle	310.2	243.5	68 600	2 655			14.87	2.58
Je m Wand	172.3	135.2	41 320	1 920	2 280	1 125	15.49	1.43

ArcelorMittal behält sich das Recht vor, die geometrischen Profileigenschaften ohne vorherige Ankündigung zu ändern

* 1 Seite, ohne Schlossinneres

INFO-SHEET

Steel Sheet Pile

SEPT. 11



ArcelorMittal

GU 20N

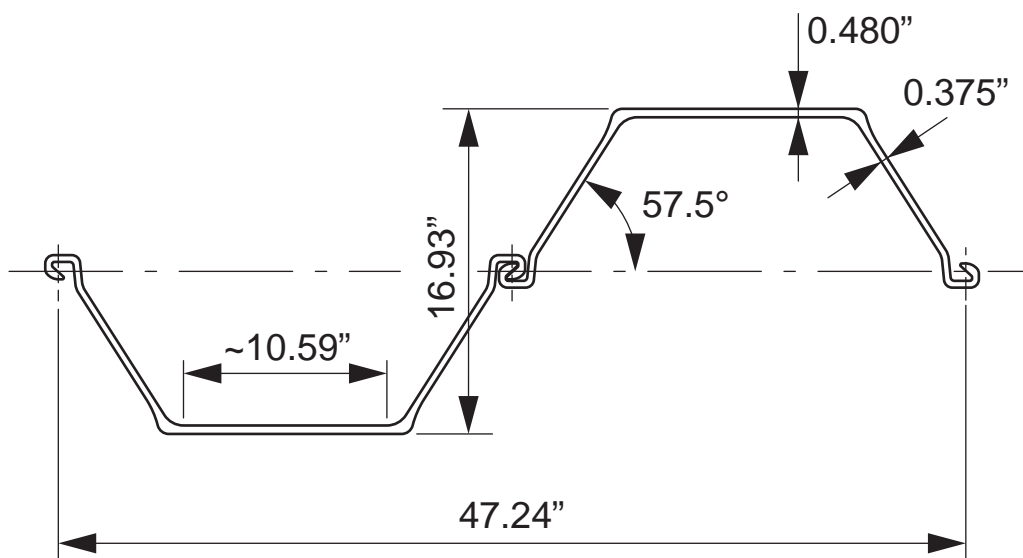

scale: 1/10

	Sectional area in ²	Mass lb / ft	Moment of inertia in ⁴	Elastic section modulus in ³	Plastic section modulus in ³	Static moment in ³	Radius of gyration in	Coating area * ft ² / ft
Single Pile	16.03	54.50	179.7	30.2			3.35	2.85
Double Pile	32.05	109.06	1 191.2	140.7			6.10	5.64
Triple Pile	48.08	163.62	1 648.1	162.0			5.85	8.46
Per ft of wall	8.14	27.69	302.6	35.7	42.4	20.9	6.10	1.43

ArcelorMittal reserves the right to change the section properties without prior notice

* 1 side, excluding inside of interlocks

ArcelorMittal Commercial RPS S.à r.l.
 Sheet Piling
 66, rue de Luxembourg
 L-4221 Esch sur Alzette | Luxembourg

T +352 5313 3105
 F +352 5313 3290
www.arcelormittal.com/sheetpiling
sheetpiling@arcelormittal.com

05.09.2011